

Pressure Gauges / Electrical Contacted Gauges / Standard Types / Ø 100 mm.
CONSTRUCTIVE PROPERTIES

	STANDARD	OPTIONAL
Mounting Type	Bottom Connection	See Technical Drawing
Scale Unit	bar/psi	bar psi kg/cm ²
Scale Range (PN)	0/0,6 0/1 0/1,6 0/2,5 0/4 0/6 0/10 0/16 0/25 0/40 0/60 0/100 0/160 0/250 0 - 315 0/400 0/600	
Vacuum Scale Range	-1 / 0 -1 / +0,6 -1 / +1,5 -1 / +3 -1 / +5 -1 / +9 -1 / +15 -1 / +24	
Case	Stainless Steel AISI-304	-
Bezel	Stainless Steel AISI-304	-
Window	Polycarbonate	-
Movement	Brass	-
Wetted Parts	Copper Alloy	-
Connection	G 1/2" B	1/2" NPT
Dial	Aluminum	-
Pointer	Aluminum	-
Welding	Soldering	Hard Soldering
Contact Types	1NO 1NC 2NONO 2NON C 2NCNC 2NCNO	Inductive

MK100DRS1
USAGE PROPERTIES

Fluid Temperature	Maximum + 60 °C	Maximum + 120 °C
Ambient Temperature	- 20 ... + 60 °C	-
Operating Pressure (max.)	Must not exceed full scale.	
Over Pressure Limit	F.S. x 1,3	-
Accuracy Class	CL 1.0	-
Protection Rate	IP 65	IP 66
Optimum Operating Range	Between 0,0 x PN and 1,0 x PN	
Storage Temperature	-40 ... +70 °C	-
Conformity	EN 837 - 1	-
Mechanical Shock Test Load	15g	-
Mechanical Vibration Test	10 Hz ile 150 Hz -1 oktav/dk. 2s / 3 eksende	

Pressure Gauges / Electrical Contacted Gauges / Standard Types / Ø 100 mm.

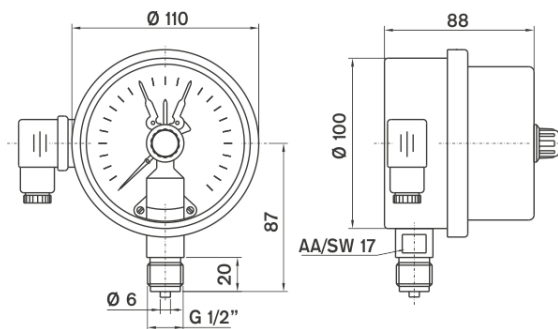

Model No: MK100DRS1

Bottom Connection

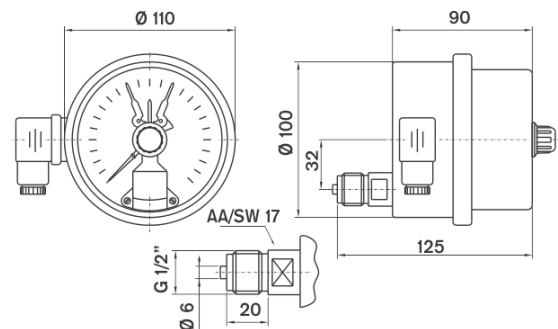

Model No: MK100DRS4

Lower Back Connection

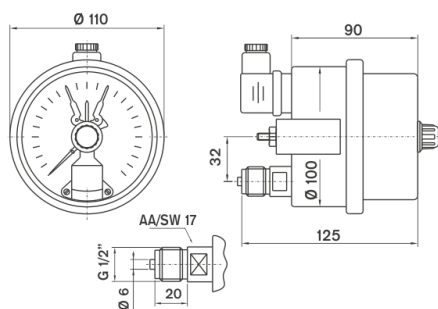

Model No: MK100DRS5

Lower Back Panel Mount Connection

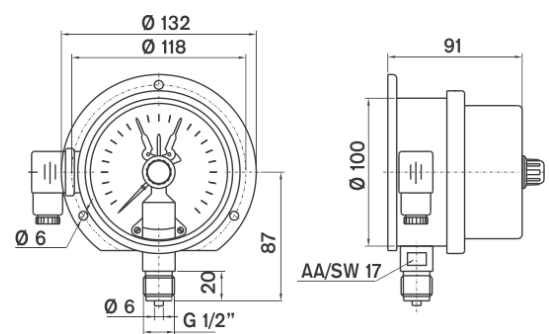

Model No: MK100DRS6

Bottom Connection with Back Flange

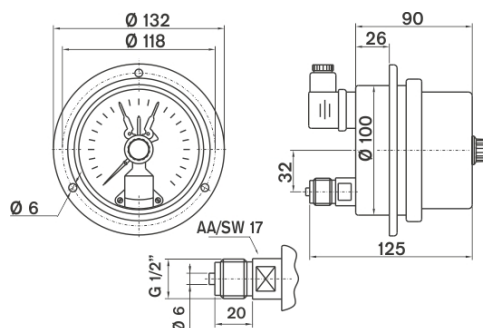

Model No: MK100DRS8

Lower Back Connection with Front Flange

Pressure Gauges / Electrical Contacted Gauges / Standard Types / Ø 100 mm.

Connection Styles of Pressure & Temperatures Gauges with Contacts

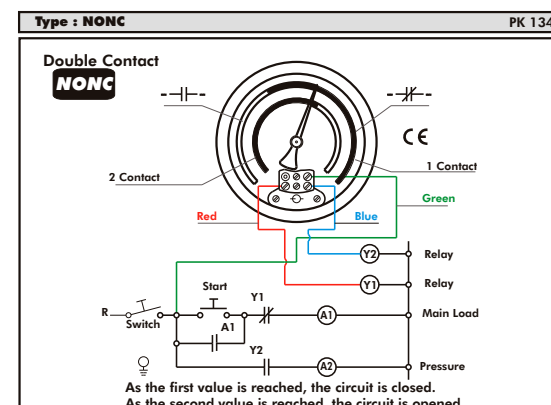
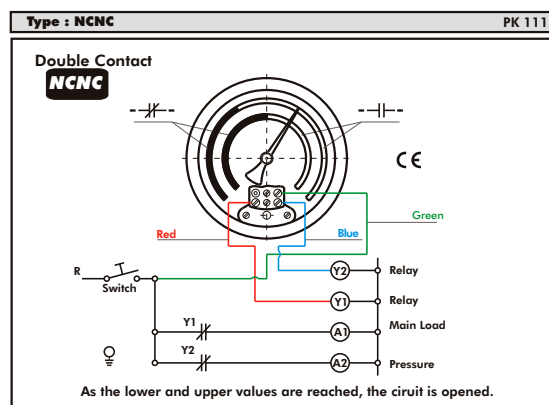
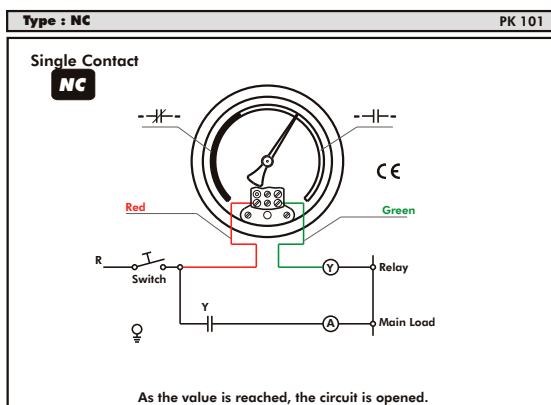
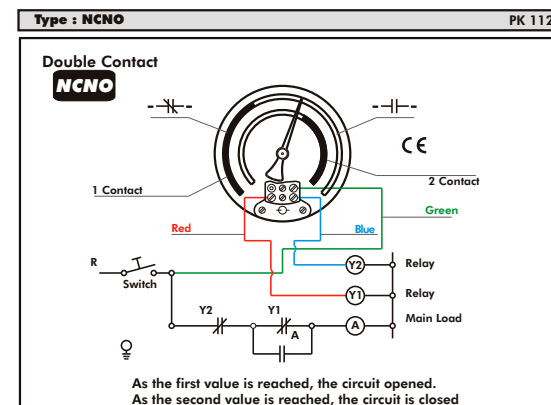
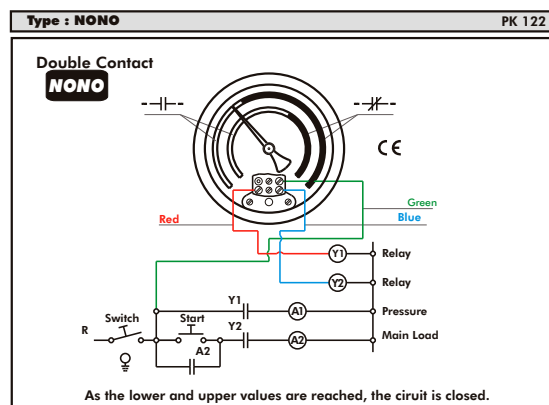
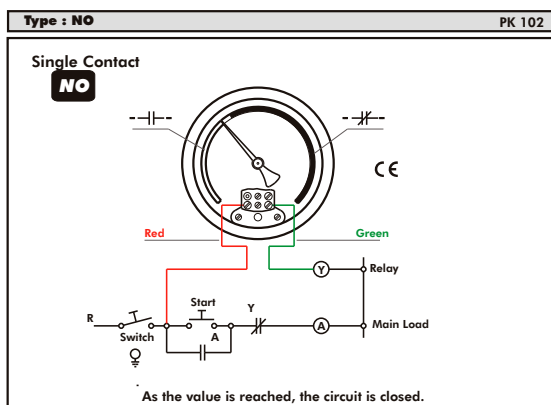

The connection circuits sketched above are recommended.

Pressure and temperature gauges shall not be directly connected to the electrical circuits. Supplementary relays having a coil current of max. 400 mA must be used.

More attention must be paid not to pass over high current over the contacts.

After suitable connection of the pressure gauges to the electrical circuit has been done, still the contact snaps frequently in presence of vibration, an isolating device, such as pulsation dampner, syphone, shall be mounted between the process connection and the gauge inlet or it is advised to use the liquid filled types.

The switching delay of the contacts changes between 2 % and 4 % of the full scale value. However, it may show variations depending on the velocity of the pointer.

Electrical Parameters				
Voltage	Direct Current	Max. Inductive Load	Switching Capacity	Max. Thermal Current
230 V	100 mA	65 mA	30 W / 50 VA	0,7 A
110 V	200 mA	130 mA		
50 V	300 mA	200 mA		
24 V	400 mA	250 mA		

ELECTRICAL CONTACT CONTROL KIT

Save time and money

We do advise this product for those whom he does not want to spend time with above diagrams.

Model No : 2650 9171 00
Elec. Contact Control Kit - 10A

EXAMPLE CONNECTION CIRCUIT for PRESSURE GAUGE with "NCNO" CONTACT

The pump pressure initially rises to the upper value it stops, as the value reaches to the lower value, again starts and cycle repeats.

